

Update on Campus and Re-location of Sports Club

- Lucy Murray-Brown - Head of Campus and Operational Models
- Councillor Roy While



Update on Campus and outdoor sport provision

31st July 2013

Cllr Roy While – Chairman of Shadow Community Operations Board

Lucy Murray Brown – Head of Campus and Operational Models

Shadow COB update

- DKA Architects appointed March 2013
- Creative advisor appointed April 2013
- 1st round of sub group meetings held May/June 2013

- Design brief development
- Working with governing bodies e.g. Amateur Swimming Association (ASA) and English Indoor Bowls Association (EIBA)
- Meetings with users e.g. Library, leisure, schools

- Key adjacencies agreed July 2013
- COB Site visits July – August 2013
- Melksham House site investigations July – August 2013 e.g. Archaeological trenches

Shadow COB update

Next Steps

- Second round of sub group meetings August – September 2013
- Pre-planning consultation – Autumn
- Planning submission – Autumn/Winter 2013
- Further updates available at www.melkshamcampus-scob.org.uk

**CONTENT SUBJECT TO PLANNING CONSENT.
ALL TIMINGS INDICATIVE.**

Outdoor Sports provision - update



CONTENT SUBJECT TO PLANNING CONSENT.
ALL TIMINGS INDICATIVE.

Woolmore Farm sports hub

- Current indicative programme targeting to complete the new facilities to enable vacant possession of the Melksham House site in Nov/Dec 2014
- New facilities to be ready early 2015
- Phased construction - focus on Melksham House initially with relative sized compound

New facilities to include:

- pitches – 1 main with stadium, 10 x training and junior pitches
- changing facilities
- officials facilities
- large club/event room with catering
- parking

**CONTENT SUBJECT TO PLANNING CONSENT.
ALL TIMINGS INDICATIVE.**

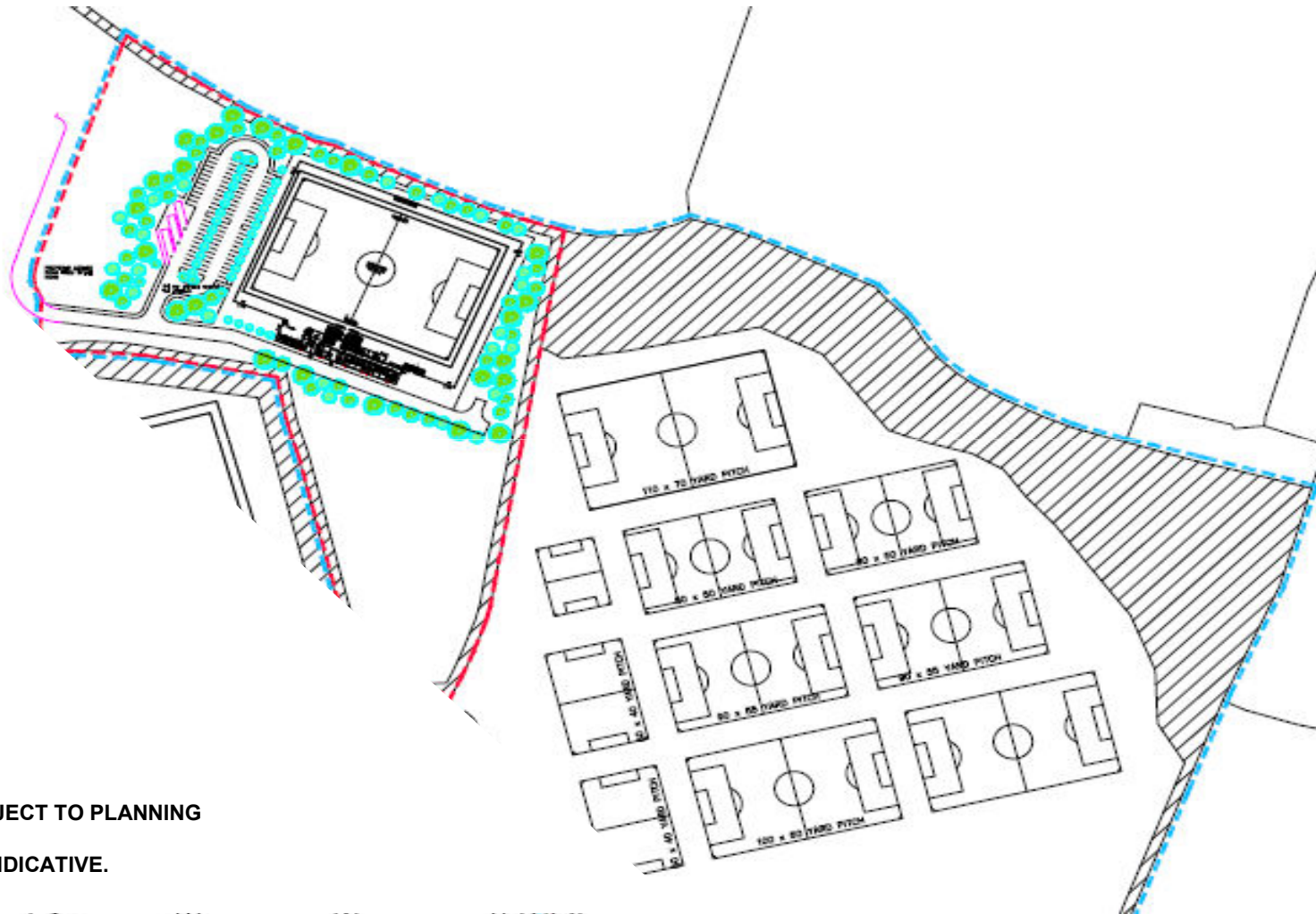

**CONTENT SUBJECT TO PLANNING
CONSENT.
ALL TIMINGS INDICATIVE.**

**CONTENT SUBJECT TO PLANNING CONSENT.
ALL TIMINGS INDICATIVE.**

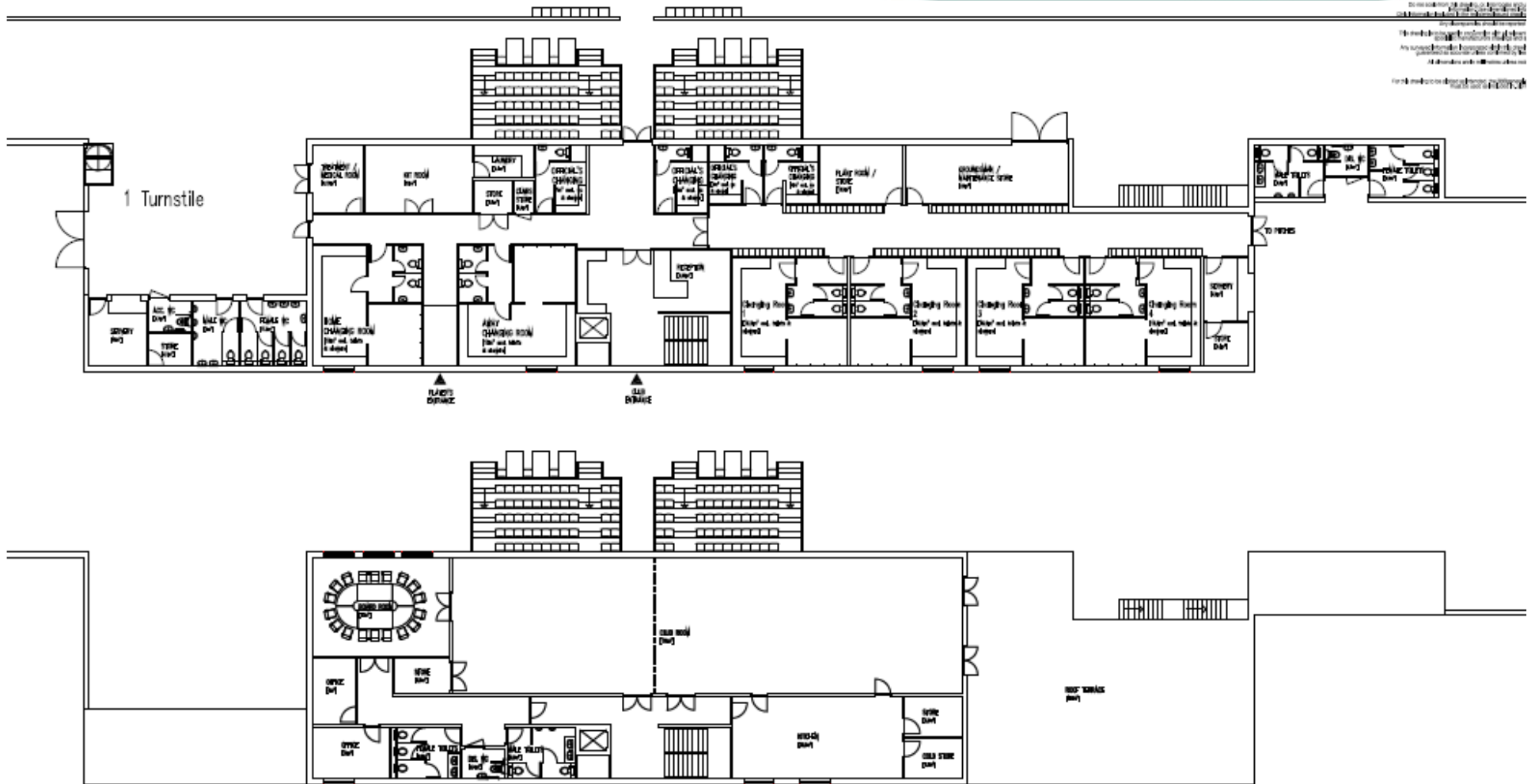

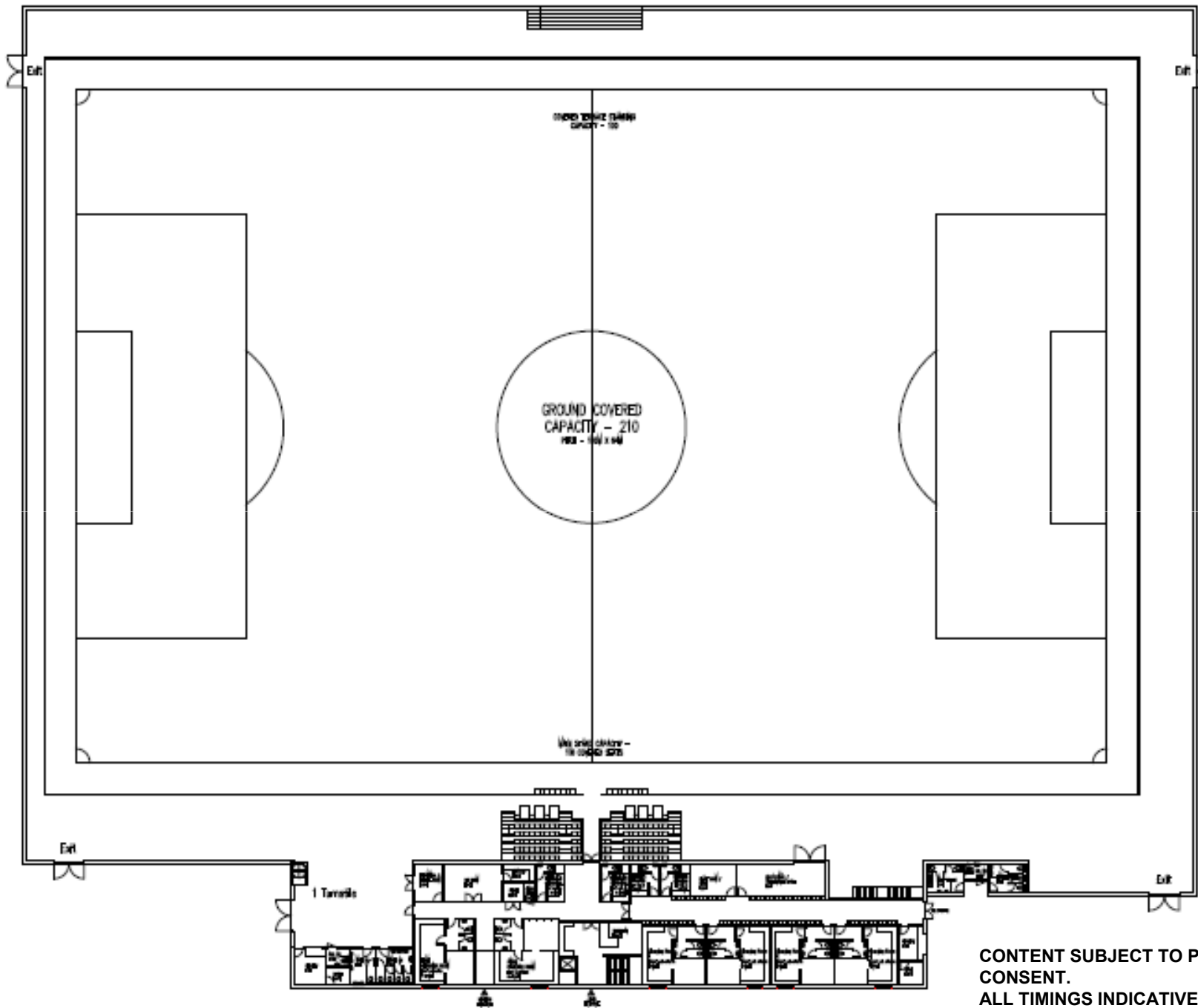

CONTENT SUBJECT TO PLANNING
CONSENT.
ALL TIMINGS INDICATIVE.

Rugby provision

- Current indicative programme targeting to complete the new facilities to enable vacant possession of the Melksham House site in Nov/Dec 2014
- New facilities to be ready early 2015
- Phased construction - focus on Melksham House initially with relative sized compound

New facilities to include:

- pitches – 1 adult main, 1 training pitch, junior and mini pitches
- changing facilities
- club room
- parking



**CONTENT SUBJECT TO PLANNING
CONSENT.
ALL TIMINGS INDICATIVE.**

Luncheon service update

- Wiltshire Council and Melksham Town Council have agreed terms of use for the luncheon service to take place at the Assembly Hall during the construction of the campus
- The luncheon service will be provided from the Assembly Hall in the latter part of 2013 – the exact date will be confirmed shortly
- The current meals service at Melksham House will continue until the service at the Assembly Hall is in place